

Picco-DENCO®

Small, yet significant

THE COMPACT CLASS

Picco-DENCO is our solution for lower capacities in a diverse range of applications. With cooling capacities up to 11 kW, it is available as a direct expansion or chilled water version over two model sizes. With EC fans as standard and features such as humidification and electric heating or low pressure hot water heating available, it is a small unit, containing a large potential.

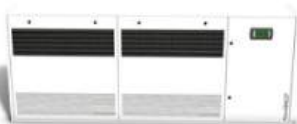

Features

- Heating options
- EC/AC Fans
- Humidification
- Remote temperature and humidity sensors
- BMS interfaces options

Picco-DENCO is our compact solution, providing full function capabilities in a unit suited for a variety of locations and applications. The design is suited to applications where capacities and air volumes are lower, but demand for close control air conditioning is no less.

Available with an upflow air configuration, the *Picco-DENCO* units can be floor or wall mounted and can operate as a chilled water version (CW) or as a direct expansion version (DX) with the latter having the compressor installed in an outdoor condensing unit.

The controls feature of the unit allows the unit to operate with duty standby conditions or as running redundancy and furthermore the ability to integrate with common BMS protocols such as Modbus, pCOWeb & BACNet.

The features are able to deliver up to 11+ kW cooling duty with possibility of no floor space being required.

Picco-DENCO®

Airflow configurations

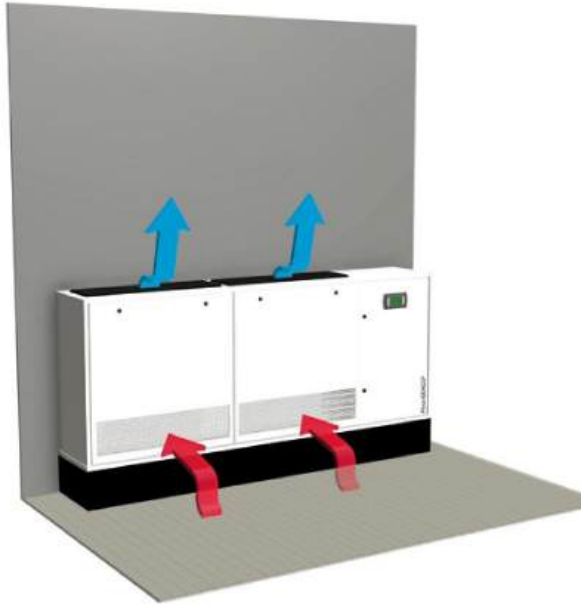

Floor configuration

With a floor configuration, air is taken in through grilles on the front doors of the unit and cold air is released into the room out of the top of the unit. Typically this configuration is used with a plinth to allow for mechanical and electrical services to enter through the bottom of the unit.

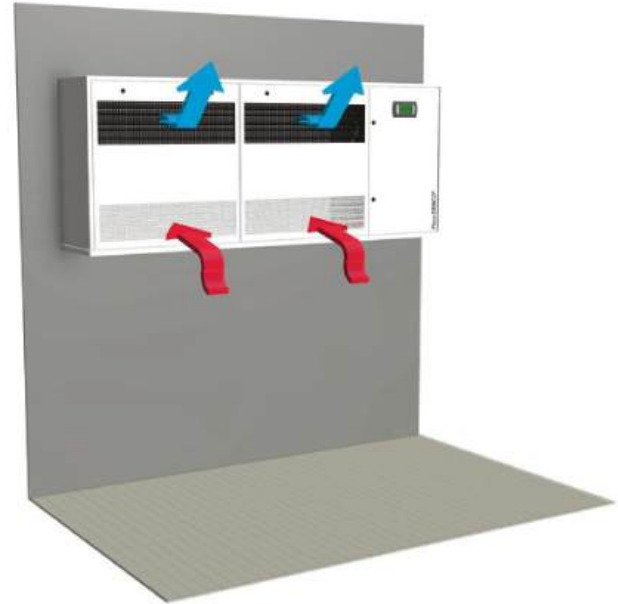

Wall configuration

For wall configuration, both supply and return air pass through the grilles on the front panels of the unit. Mechanical services are also supplied through the bottom panel of this configuration.

Picco-Denco®

Unit Sizes		007	011	007	011
Cooling Type		DX	DX	CW	CW
Cooling Duty (Gross Total)	kW	7.6	11	6.2	15.2
Airflow	m ³ /h	1,260	2,880	1,260	2,880
Power Input	kW	2.3	3.4	0.1	0.5
Width	mm	1,400	2,000	1,400	2,000
Depth	mm	300	360	300	360
Height	mm	800	800	800	800
Weight	kg	85	120	85	120

Return air conditions: 24 °C / 50 % R.H.

X-Version (DX): ambient: 32 °C. Power input includes typical outdoor condensing unit.

C-Version (CW): 100 % water, Delta T = 5 K (7 / 12 °C)

Weights and dimensions are approximate representations and will vary depending on features installed and version selected.

For more information see specific unit drawings.